

SECTION NF

REAR AXLE and ROAD WHEELS

REAR AXLE AND ROAD WHEELS

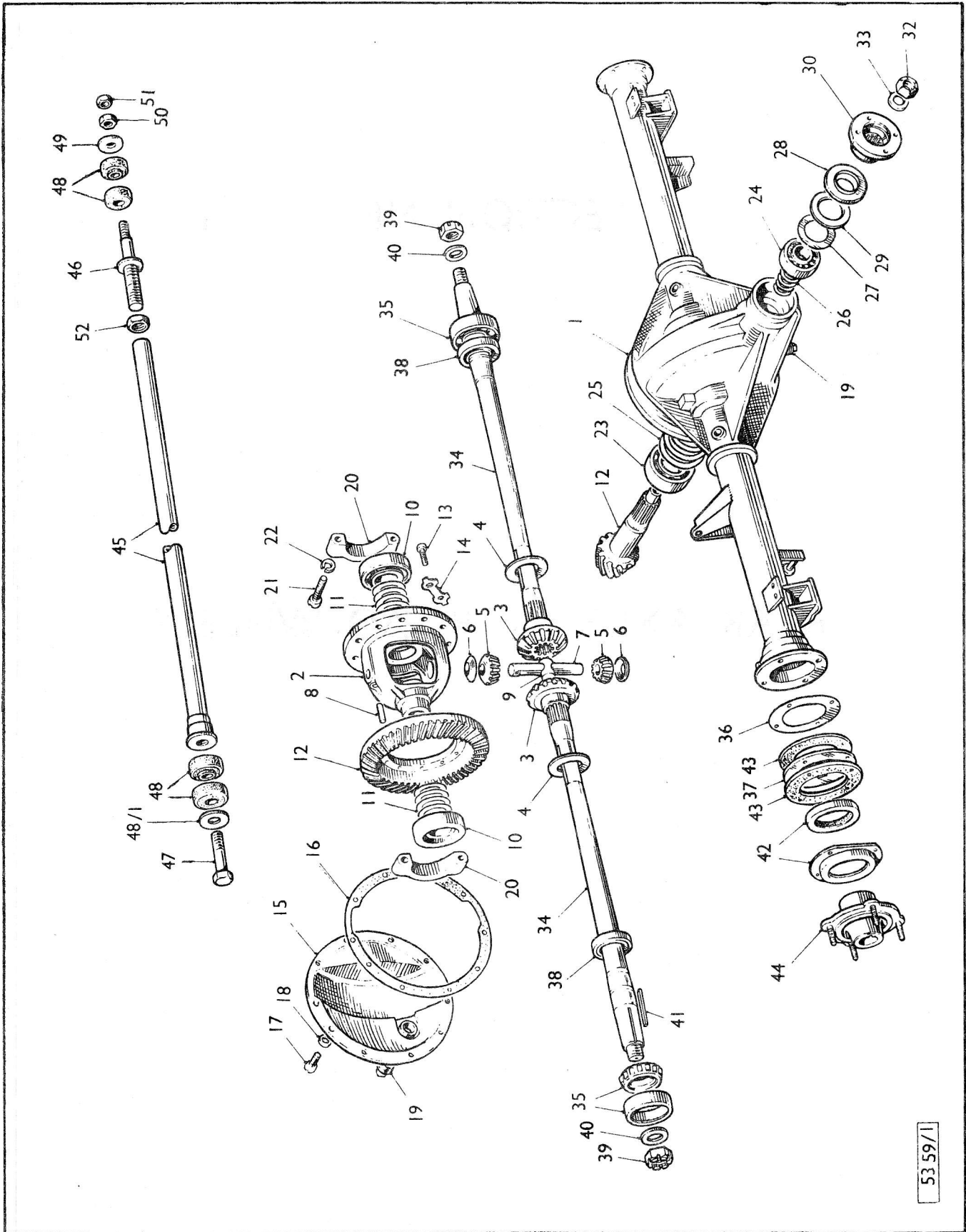

53 59/1

SECTION NF

REAR AXLE AND ROAD WHEELS

Plate Ref.	Rootes Part Number	DESCRIPTION	No. per Veh.	REMARKS
		REAR AXLE UNIT		
	5042516	Casing—Rear axle	1	Not supplied
1	5058346	Casing—Rear axle	1	Mk. I
2	5042697	Differential case	1	Mk. II
3	5042521	Differential side gears	2	
4	5042522	Thrust washer—Differential side gears	2	
5	5042523	Differential pinion mate	2	
6	5042524	Thrust washer—Differential pinion mate	2	
7	5042526	Shaft—Differential pinion mate	1	
8	K.28139	Lockpin—Shaft	1	
9	5042527	Spacer—Axle shaft	1	
10	P.43906	Bearing—Differential	2	
11	5042528	Shim, .003" } Differential bearing	A/R	
	5042529		A/R	
	5042530		A/R	
	5042531		A/R	
12	5042517	CROWN WHEEL AND BEVEL PINION	1	
13	5042693	Screw—Crown wheel	10	
14	5042518	Lockstrap—Screw	5	
15	5042694	Gear carrier cover	1	
16	5042519	Gasket	1	
17	19605051	Screw ... } Cover	10	
18	9661203		Lockwasher	10
19	K.28087	Filler and drain plugs	2	
20	5042520	Cap—Differential bearing	2	
21	5042696	Screw ... } Differential bearing cap	4	
22	9660321		Lockwasher	4
	1224359	Steady bracket bearing	1	
23	5042698	Pinion bearing—Inner	1	
24	5042699	Pinion bearing—Outer	1	
25	K.28148	Adjusting shim inner, .003" } Pinion bearing	A/R	
	K.28149		A/R	
	K.28058		A/R	
26	K.28059	Adjusting shim outer, .003" } Pinion bearing	A/R	
	K.28060		A/R	
	K.28061		A/R	
	K.28062		A/R	
	5042700	Pinion bearing washer	A/R	
27	5042539	Pinion oil slinger	1	
28	K.28065	Pinion oil seal	1	
29	K.28066	Gasket—Pinion oil seal	1	
	5042541	Driver coupling (Companion flange)	1	} Mk. I
	K.28067	Dust shield—Driver coupling	1	
30	5058347	Driver coupling (Companion flange) c/w dust shield	1	Mk. II
32	5042702	Nut } Pinion	1	
33	5220710		Washer	1
34	5042703	Axle shaft	2	
35	5042684	Bearing	2	
36	K.28079	Shim, .003" } Axle shaft	A/R	
	K.28080		A/R	
	K.28081		A/R	
	K.28082		A/R	

REAR AXLE AND ROAD WHEELS

Plate Ref.	Rootes Part Number	DESCRIPTION	No. per Veh.	REMARKS
		REAR AXLE UNIT—continued		
37	5043255	Bearing retainer—Axle shaft	2	
38	5042685	Oil seal	2	
39	5042686	Nut } Axle	2	
40	5042687	Washer } shaft	2	
41	K.28076	Key	2	Superseded by 5042688
	5042688	Key	2	
42	5042689	Hub oil seal	2	
43	5042690	Gasket—Oil seal	4	
	5042691	Bolt } Brake	8	
	5042692	Nut } backplate	8	
44	1224649	HUB c/w Bolts	2	
	1214407	Bolt—Road wheel	8	
		PANHARD ROD		
		PANHARD ROD COMPLETE—Not supplied		
	1224786	Panhard rod tube c/w plug	1	Mk. I
45	1236133	Panhard rod tube c/w plug	1	Mk. II
46	1224784	Spigot end—Panhard rod	1	
47	1224789	Bolt—Panhard rod plug end	1	
48	K.23618	Rubber bush—Panhard rod	4	
	9067054	Washer, 7/16" plain } Bolt	1	Up to B382001761
48/1	9067499	Washer, 7/16" plain } end	1	
	9067044	Washer, 3/8" plain	1	Up to B382001761
49	9067494	Washer, 3/8" plain	1	From B.382001762
50	5220703	Nut, 3/8" UNF. ... } Spigot end	1	
51	9520060	Nut, 3/4" UNF. lock	1	
52	9520100	Nut, 5/8" UNF. lock	1	
		ROAD WHEELS		
	1214930	ROAD WHEEL (Disc Type)	5	Not supplied
		Tyre, 5-90 x 13		
	1207244	Nave plate	4	
	1224813	Wheel trim	4	Up to B9473167
	1206741	Wheel trim	4	
	9228002	Balance weight—1/2 oz.	A/R	
	9228003	Balance weight—1 oz.	A/R	
	9228004	Balance weight—1 1/2 oz.	A/R	
	9228005	Balance weight—2 oz.	A/R	